

ELEVATION
1:250
A-A

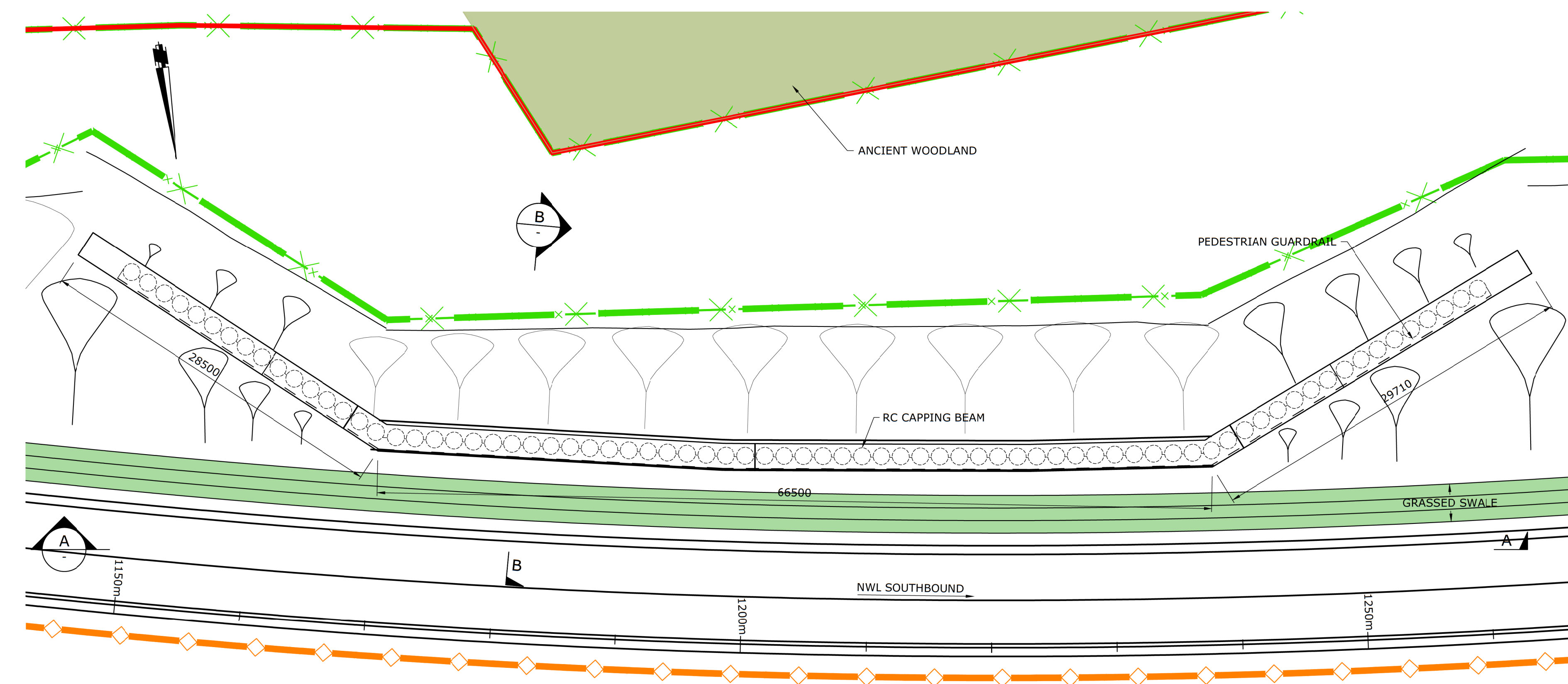

PLAN
1:250

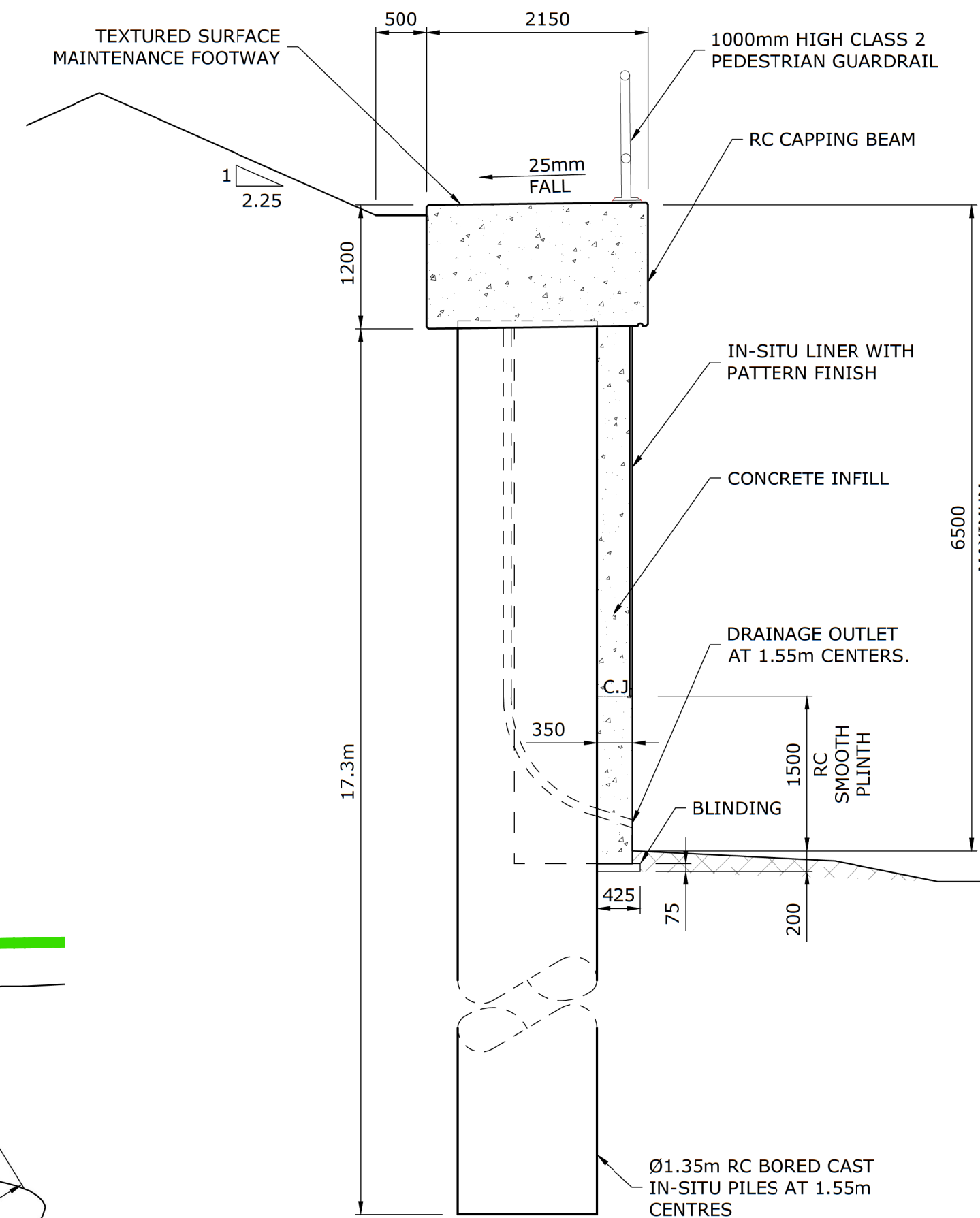

SECTION
1:50
B-B

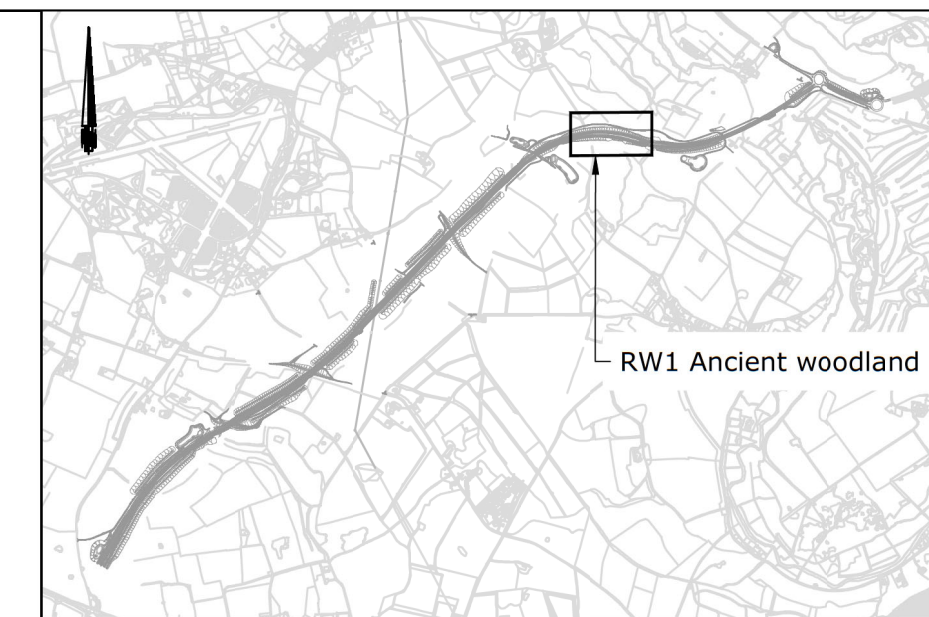

Key Plan

Notes:

1. This drawing shall only be used for the design element in the drawing title.
2. Only written dimensions shall be used.
3. All dimensions in millimetres unless noted otherwise.
4. All levels are in metres related to ordnance datum (A.O.D.)
5. All chainages are in metres unless noted otherwise.
6. For highway geometric design refer to 2.05.00 Long Section Drawings PK1002-RAM-HGN-MLE-DR-CH-2608 Long Section Southbound Sheet 7 of 16.
7. Please refer to 3.03.00 Environmental Statement Chapter 3: Description of Scheme for the Rochdale Envelope flexibility included within the design for the purposes of Environmental Impact Assessment.
8. This drawing is for planning application purposes only, it is not a construction issue drawing.

Key:

- Environmental Fencing
- Permanent Boundary Fence
- Single VRS
- Dual VRS (Central Reserve)
- Red Line Boundary

Mapping reproduced by permission of Ordnance Survey on behalf of HMSO.
© Crown copyright and database rights 2024 Ordnance Survey 100019340.

A1 - Authorised for Planning

C01	SM	SA	SS	08/02/24
REVISION	DRAWN	CHECKED	APPROVED	DATE

CLIENT

Norfolk County Council
Grahame Bygrave
Interim Executive Director of
Community and Environmental Services
Norfolk County Council
County Hall, Martineau Lane
Norwich NR1 2SG

PROJECT



DRAWING TITLE
NORWICH WESTERN LINK
ANCIENT WOODLAND RETAINING WALL RW1
GENERAL ARRANGEMENT
SHEET 1

DRAWING STATUS
A1 - AUTHORISED FOR PLANNING

DRAWN	CHECKED	APPROVED	AUTHORISED
SM	SA	SS	FQC

SCALE @ A1 SIZE	DATE	REVISION
AS SHOWN	08/02/24	C01

DRAWING NUMBER

PK1002-RAM-SBR-RW1-DR-CB-1701